

### Single-lever wall-mount bath/shower mixer 12778D-4



Collection: STILLNESS

Finish\*:



CP - Polished  
Chrome

### Features

- Weight: 3.5 kg
- Flow rate: 23 l/min
- Hole configuration:  $150 \pm 15$  mm
- Temperature limiter ring
- Non-return valves on shower outlet
- Installation: Wall-mount
- Connection: With connectors and wall escutcheons
- Streamlined element, pure design and industrial integrity lend aesthetic functionality to minimal spaces
- Discreetly-positioned automatic diverter

### Technical drawing

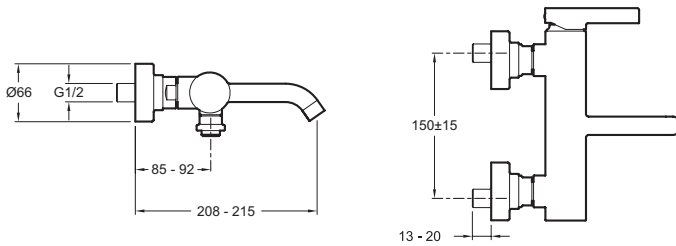

Product Specification: Single-lever wall-mount bath/shower mixer. 12778D-4. Collection: STILLNESS. Weight: 3.5 kg. Installation: Wall-mount. Flow rate: 23 l/min. Connection: With connectors and wall escutcheons. Hole configuration:  $150 \pm 15$  mm. Streamlined element, pure design and industrial integrity lend aesthetic functionality to minimal spaces. Temperature limiter ring. Discreetly-positioned automatic diverter. Non-return valves on shower outlet.