

### Articulating single lever sink mixer 6227D



Collection: KARBON

Finish\*:



CP - Polished  
Chrome



VS - Vibrant  
Stainless

Main features:



### Features

- Weight: 4 kg
- Flow rate: 6.8 l/min
- Connection: With supply hoses
- 5 articulations for perfect mobility and positioning
- Deck-mount joystick lever next to the spout (drilling  $\varnothing$  51 mm)
- Installation: 2 holes
- Flow rate: 6.8 l/min
- Mechanism: Ceramic cartridge "joystick" type
- 2 delivery options: Forceful spray and laminar stream

### Technical drawing

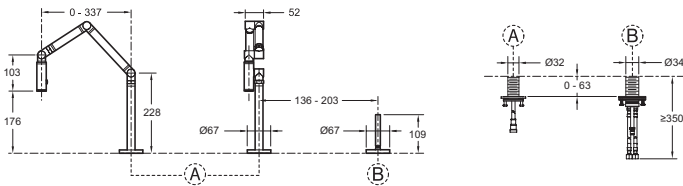

Product Specification: Articulating single lever sink mixer. 6227D. Collection: KARBON. Weight: 4 kg. Installation: 2 holes. Flow rate: 6.8 l/min. Flow rate: 6.8 l/min. Connection: With supply hoses. Mechanism: Ceramic cartridge "joystick" type. 5 articulations for perfect mobility and positioning. 2 delivery options: Forceful spray and laminar stream. Deck-mount joystick lever next to the spout (drilling  $\varnothing$  51 mm).