

Single-lever sink mixer 16084D-4

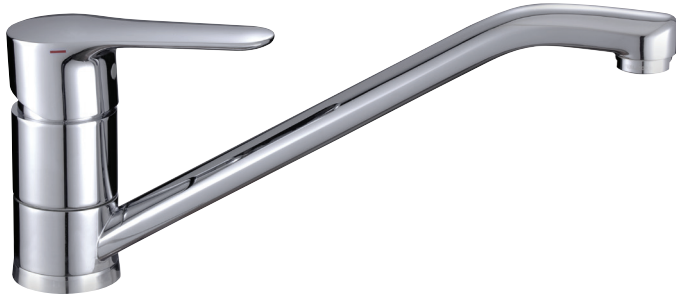

Collection: JULY

Finish*:



CP - Polished
Chrome

Main features:



Features

- Weight: 1.2 kg
- Flow rate: 12 l/min
- Spout 250 mm
- Anti-scale aerator
- Installation: 1 hole
- Mechanism: Ceramic disc cartridge with temperature and flow limiter
- Temperature limiter ring

Technical drawing

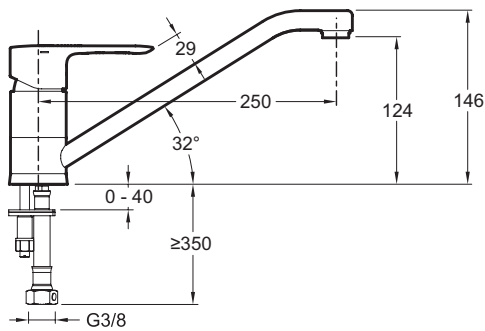

Product Specification: Single-lever sink mixer. 16084D-4. Collection: JULY. Weight: 1.2 kg. Installation: 1 hole. Flow rate: 12 l/min. Mechanism: Ceramic disc cartridge with temperature and flow limiter. Spout 250 mm. Temperature limiter ring. Anti-scale aerator.